

SERIAL NUMBER RULES FOR PHOTOVOLTAIC PANELS



SPV involves a solar installer using a phone app to scan solar panel serial numbers just prior to installation, which are checked against a database to ensure they match information verified by the Clean Energy Council. Please keep the SolarQuotes blog constructive and useful with these 5 rules: 1. Real names are preferred - you should be



Can I build my own Solar Panel System UK? - DIY Solar; Getting Solar Panel Quotes in the UK 2024; How much Space do I need for Solar Panels? UK Guide 2024; The Smart Export Guarantee (SEG) UK; Solar Panels for New Builds: A UK Guide for 2024; Solar Panels for Schools and Colleges in the UK; How Much Electricity Does a Solar Panel Produce, UK?



The total number of modules on each channel is different, but the number of modules on each string within Channel A and B are the same (eight on Channel A, five on Channel B). Great explanation on how solar panel works. Thanks for the information. Reply. Philip says: 16. Sep. 2018 at 05:25



The validation process is carried out by a smartphone application. The installer scans the serial number and sends the data for validation via the app. The validation service checks the serial number against the database of serial ???



3. Serial Number label: A unique serial number which is laminated inside the module permanently which can be found in the front of the module. There is another same serial number beside the module nameplate. 2. Current classification label: Rated working current. (H indicates High, M indicates Medium, L indicates Low) 03.

SERIAL NUMBER RULES FOR PHOTOVOLTAIC PANELS



The apps let installers scan serial numbers and request verification against the database. If verified, installers can receive confirmation within seconds. The apps also send consumers a confirmation of their verified panels. This record includes the: solar panel make and model; serial numbers; time and date of installation; location of



Register your solar PV and/or battery storage Step 1: Installer should be appropriately registered Energy device owners should commission an installation contractor, discuss the proposed



Understanding solar panel connections is crucial for both efficiency and safety. As solar panels become increasingly affordable, newcomers and seasoned users expanding their systems stand to gain optimal energy outputs through a deeper knowledge of how different wiring methods affect the characteristics of their solar string. Equipped with that



Has the inverter been replaced without updating the serial number in the monitoring platform? Go to Admin ???Logical Layout to enter the correct serial Check if the string was designed according to the SolarEdge design rules Re-design Re-pair Check on-site all series connections of the string: Cable, connectors, combiner boxes, DC



I talked with SunPower tech support today, and they sent me the attached PDF that allowed me to decode the serial numbers on my used panels. (It turns out I bought 6 year old panels that were represented as 2 years old. I wish I had known how to check serial numbers ???

SERIAL NUMBER RULES FOR PHOTOVOLTAIC PANELS



The maximum number of solar panels you can connect in a string is determined by the maximum input voltage of your inverter or charge controller. You can find this value on the inverter datasheet. If you have a solar panel that has a V_{oc} (at STC) of 40V, and a Temperature Coefficient of $0.27\%/^{\circ}\text{C}$. Then for every degree celsius drop in panel



??? Model number ??? Barcode and serial numbers of all modules in the pallet. The serial number is the unique identifier of each PV module. A protected copy of the barcode is located on the front top-left corner under the glass and cannot be removed or damaged. The matching serial number is located on the frame and on the rear of the module.



Since the introduction of the feed-in tariff (FIT) scheme in 2010, an increasing number of consumers have installed renewable electricity generating equipment, such as solar photovoltaic (PV) at



Solar Module Cell: The solar cell is a two-terminal device. One is positive (anode) and the other is negative (cathode). A solar cell arrangement is known as solar module or solar panel where solar panel arrangement is known as ???



3. Enter the panel's max power current in amps (denoted I_{mp} or I_{mpp}). It may also be called the optimum operating current. 4. In the Quantity field, enter the number of this type of solar panel you'll be wiring together. 5. If ???

SERIAL NUMBER RULES FOR PHOTOVOLTAIC PANELS

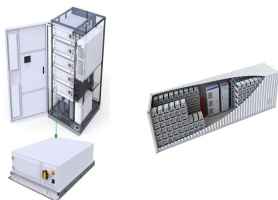

Connecting more than one solar panel in series, in parallel or in a mixed-mode is an effective and easy way not only to build a cost-effective solar panel system but also helps us add more solar panels in the future to meet our increasing daily needs for electricity. It's practical your solar array to comprise an even number of panels (a



In this specifications document, you'll find information on capturing PV module serial numbers, digital twins, Investment Tax Credit (ITC) Eligibility, and the practices to follow to successfully complete a solar site's PV module serial ???



4) Click on the "module"/"panel" you want to know more about and you can find the serial number for that panel. To map it to your layout look at the X and Y values for placement. In my case I had to read it from bottom right to bottom left and then upper right to upper left to map the serials to my panels. X is the horizontal position and Y



Power Standard Photovoltaic Module Version 2024_V1.4_EN . Wuxi Suntech Power Co., Ltd. Address: No.9 Xinhua Road, Xinwu District Wuxi, China 214028 Read and understand all safety rules before installing, wiring, operating, or maintaining module s. When strictly comply with the upper limit on the number of layers printed on the packing



If you have installed solar PV panels or other eligible renewable electricity generation in your home or business, you may be able to earn money through the Smart Export Guarantee (SEG).

SERIAL NUMBER RULES FOR PHOTOVOLTAIC PANELS



3. Barcode: each individual module has a unique serial number. The serial number has 16 digits. The 1st and the 2nd digits are the year code, and the 3th is the month code (A, B, C stands for October, November and December respectively). For example, 121PXXXXXXXXXXXXXX means the module was assembled and tested in the January of 2012.



1.4 Product Serial Identification Serial Number Rule: WXXYZZZZZZZ
Where: W ??? represents year of manufacture XX ??? represents the week of manufacture Y ??? represents the Factory location ZZZZZZZ ??? unique identification number assigned to each module. 2.0 Safety Precautions



A letter/email from the housing developer stating that the solar panels came with the purchase of the property and are not leased. A fixtures and fitting list with the solar panels listed, along with the Land Registry for the property. Meter details (make, model, serial number) A clear picture of the meter, showing the make, model and



Serial Number label: A unique serial number which is laminated inside the module permanently which can be found in the 60 type PV module cable length ???1.2m, 72 type PV module cable length ???1.4m, 78 type PV module cable length ???1.5m Vertical Installation:



In order to understand the rules of solar panel wiring, it is necessary to understand a few key electrical terms ??? particularly voltage, current, and power ??? and how they relate to each other. The number of solar panels you can ???

SERIAL NUMBER RULES FOR PHOTOVOLTAIC PANELS



Look for a long alphanumeric code, which is the serial number. The serial number is often prefixed by "SN" or simply listed as "Serial Number."

4. Alternative Methods: Manuals and Documentation: Sometimes the serial number is also listed in the product manuals or documentation provided with the purchase of the PV module.



Serial Number label: A unique serial number which is laminated inside the module permanently which can be found in the front of the module. There is another same serial number beside the ???



Here's what you need to know about solar panel parallel vs series vs series-parallel connections. You could have any number of panels connected in this manner although 2-8 panels are common for small solar DIY projects. As a general rule, PV modules rated at over 50W need 10 AWG cabling.



Easily scan serial numbers with the Solar Insights mobile app. The Zeitview Solar Insights mobile app makes scanning PV module serial numbers a breeze. Using the mobile app, field technicians can scan serial numbers quickly using their mobile device's camera or bluetooth scanner, and can even type in serial numbers if the barcode is degraded.



Every solar panel typically comes with a female and a male MC4 connector. Usually, the female MC4 connector stands for the negative terminal, and the male MC4 connector represents the positive terminal of the ???

SERIAL NUMBER RULES FOR PHOTOVOLTAIC PANELS



As already mentioned, the serial number of a solar panel (photovoltaic module) uniquely identifies it from all the other solar panels. There can be no doubt about which panel is referred to when using the serial number. When a solar panel is being moved or replaced, it is an easy and faultless way to keep referring to the same panel.



While single photovoltaic cells can be used directly in certain devices, for solar power generation one usually uses solar modules (also called solar panels), which contain multiple photovoltaic cells. There are also hybrid modules that also generate heat (see below), but these are far less common than pure photovoltaic modules. Most solar panels have a rigid construction with a ???